

8925.24

SPLICE UP-SP TERMINALS



Description Special terminals - End splices plane

Wire section range 0.50 – 1.00 mm² (AWG 20 - 18)

Max. Insulator Ø 2.9 mm



Materials, Temperature & Contact resistance

Part nr.	Material	Finish	Max. temp. (C°)
8925.24	Steel	Nickel-plated	300

Material thickness 0.3 mm

Application tool MN8925

Wire striping length 3.30 (±0.5) mm

Crimping parameters & Pull out force

Wire section (mm ² ±10%)	Conductor (mm)		Insulator (mm)	Pull-out force (N) (min.)
	Height (±0,05)	Width (measured)	Width (measured)	
Nominal				
0.50	1.25	2.06	3.05	90
0.75	1.35	2.07	3.06	130
1.00	1.45	2.07	3.07	170

Note: Values only valid for the application tool specified. The insulator width is only indicative as they depend of the insulation properties.

Packaging 15000 Pieces on 300 mm Ø x 160 mm wide cardboard reel, 12.5 mm terminal chain pitch

Drawing

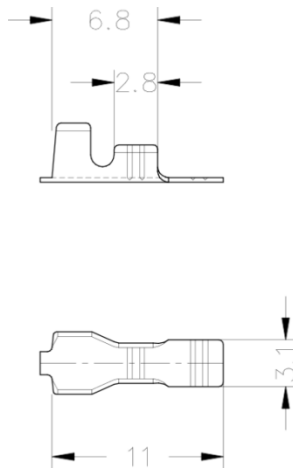

Approvals

RoHS Compliant	
----------------	--

Disclaimer

Data obtained from Escubedo Laboratory essays, using own methodology, cablings, equipment and original crimping tools, done in laboratory conditions and following the indicated standards, errors and omissions excepted. This document has no contractual meaning and it is publicised only for informative purposes. It can be changed without prior notice. The end customer has the sole responsibility to check these characteristics in its environment and with its own components, manufacturing methods and equipment. See also the full range product overview if available. For further information please visit our web site or contact us.

Rev. Nr.	Concept	Date	Created/Revised	Approved
2	Sheet format update	05/05/2017	D.Martinez / E.Roura	X.Menac
1	Creation	16/10/2014	D.Martinez/E.Roura	Joan Carles Sanchez