

4408.**

2.8 MM (.187) UP-STA TERMINALS



Description Receptacles For standard tabs. Rear dimple for tab 4.8*0.5

Wire section range 0.50 – 1.00 mm² (AWG 20 - 18)

Max. Insulator Ø 2.5 mm.

Materials, Temperature & Contact resistance

Part nr.	Material	Finishing	Max. temp. (C°)	Resist. (mΩ)	UL regulation
4408.00	Brass	Natural	110	(T.B.D.)	
4408.02	Brass	Tin plated	120	(T.B.D.)	
4408.30	Bronze	Natural	120	(T.B.D.)	-
4408.32	Bronze	Tin plated	130	(T.B.D.)	-

Notes: Temperatures as per IEC 61210 standard.
Maximal contact resistance: only contact zone

Material thickness 0,25 mm

Max. Rated current

Wire section (mm ²)	Current (A)
0.50	6
0.75	8
1.00	8

Note: Current carrying capacity according to wire size (IEC 60760)



Insertion/Withdrawal forces

	Natural	Tin Plated
1st. Insertion	40 N Max	50 N Max
1st. Withdrawal	40 N Max	50 N Max
6th. Withdrawal	6 N Min	8 N Min

Application tool MN4306

Wire stripping length 3.8 (±0.5) mm

Crimping parameters & Pull out force

Wire section (mm ² ±10%)		Conductor (±0,05)		Insulator (±0,15)	Pull-out force (N)	
Nominal	Actual	Height (mm.)	Width (mm.)	Width (mm.)	DIN64249	ESCUBEDO
0.50	0.45	1.00	2.03	3.04	≥ 60	>70
0.75	0.71	1.10	2.04	3.04	≥ 70	>80
1.00	0.91	1.20	2.05	3.06	≥ 80	>90

Note: Values only valid for the application tool specified upwards. The insulator widths are only indicative as they are dependent on the sheath thickness of the wire used.

Packaging 15000 Pieces on 300 mm. Ø x 160 mm. wide cardboard reel, 16.5 mm terminal chain pitch

Drawing

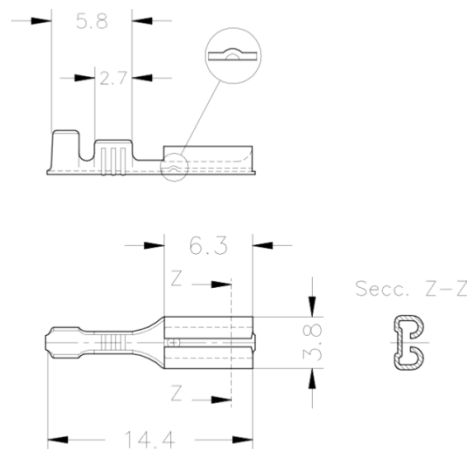

Approvals

- RoHS Compliant
- UL (see table above)



Disclaimer

Data obtained from Escubedo Laboratory essays, using own methodology, cablings, equipment and original crimping tools, done in laboratory conditions and following the indicated standards, errors and omissions excepted. This document has no contractual meaning and it is published only for informative purposes. It can be changed without prior notice. The end customer has the sole responsibility to check these characteristics in its environment and with its own components, manufacturing methods and equipment. See also the full range product overview if available. For further information please visit our web site or contact us.

Rev. Nr.	Modification	Date	Created/Revised	Approved
1	Creation/Update	16/05/2014	D.Martinez/E.Roura	A.Calvet