

Product Overview / Características Principales

4766.00

Description / Descripción: Receptacle 5.2 SEK Hembra 5.2 SEK
For / Para: 5.2 x 0.5 Tab / Macho 5.2 x 0.5
Wire size range / Rango de sección de cable: 0.5 – 1.25 mm <sup>2</sup>
Maximal insulator diameter / Diámetro máximo aislante: 4.1 mm
Strip – length / Longitud de pelada: 4.0 ± 0.5 mm
Application Tool / Util de engaste: <b>MN4766</b>
Material / Material: Natural Brass / Latón Natural

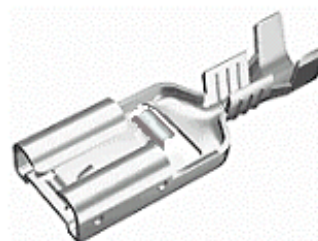

Test values / Resultados de ensayos

Insertion and withdrawal force / Esfuerzo introducción-extracción				
	1° insertion/ 1° introducción	1° withdrawal/ 1° extracción	6° withdrawal/ 6° extracción	10° withdrawal/ 10° extracción
CEI760	67 N max.	89 N max.	-	-
ESCUBEDO	18 N max.	80 N min.	-	-

Current carrying capacity with maximal suitable wire size ( IEC 760 ) Capacidad de paso de corriente con la sección de cable mayor ( CEI 760 )	12A	
Maximal temperature ( DIN 61210 ) Temperatura máxima ( DIN 61210 )	110°C	Typical value Valor típico
Maximal contact resistance with minimal suitable wire size ( IEC 760 ) Máxima resistencia de contacto con la sección de cable menor ( CEI 760 )	2.4mΩ	1.2mΩ
Electrical test done with tab 4.8*0.5 / Ensayos electricos hechos con machos 4.8*0.5		

Pull-out force / Fuerza de tracción		
Wire size / Sección	DIN 46249	typical
0.5 mm <sup>2</sup>	80 N	121N
0.75 mm <sup>2</sup>	120 N	157N
1.0 mm <sup>2</sup>	160 N	187N
1.25 mm <sup>2</sup>	160 N	259N

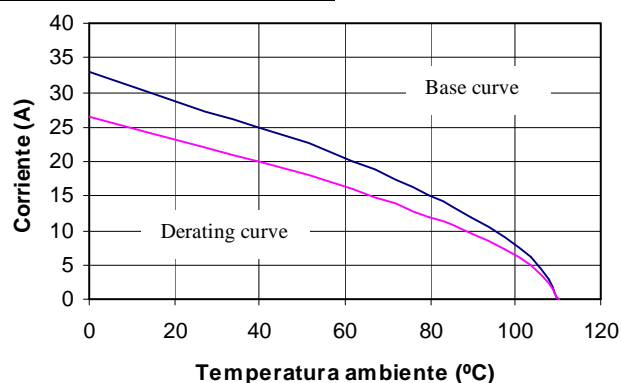

Crimp data / Datos de engastadura				
Wire size / Sección	Conductor		Insulator / Aislante	
	Altura	Anchura	Altura	Anchura
0.5 mm <sup>2</sup>	1.39	2.35	2.66	3.09
0.75 mm <sup>2</sup>	1.48	2.35	2.86	3.1
1.0 mm <sup>2</sup>	1.56	2.35	2.97	3.11
1.25 mm <sup>2</sup>	1.6	2.37	3.05	3.12

Values only valid for the application tool specified upwards / Valores válidos únicamente para el útil de engaste especificado arriba

Further information on request / Para más información consultar <a href="mailto:info@escubedo.com">info@escubedo.com</a>				
1	Creation & Derating	10/03/2011	David Martinez	Angela Arevalo
Nr/Nº	Modification/Modificación	Date/Fecha	Name/ Nombre	Approved / Aprobado

Disclaimer:

Data obtained from Escubedo Laboratory essays, using own methodology, cablings and equipment, done in laboratory conditions and following the indicated standards, errors and omissions excepted. This document has no contractual meaning and it is published only for informative purposes. It can be changed without prior notice. The end customer has the sole responsibility to check these characteristics in its environment and with its own components, manufacturing methods and equipment. See also the full range product overview if available. For further information please visit our web site or contact us.